



September 2, 2011

ADDENDUM NO. 2

CONTRACT NO. 2012-BT-4
SAN RAFAEL BUS LOT ENTRANCE IMPROVEMENTS

To All Prospective Bidders:

The Golden Gate Bridge, Highway and Transportation District (District) herewith issues Addendum No. 2 to the above-referenced Bid. Addendum No. 2 is hereby incorporated and made part of the Bid Documents. Except as specifically modified by this document, all other terms and conditions remain in full force and effect.

This Addendum is available for download at no charge on the District's website. To download the document, open the District's web site home page at <http://www.goldengate.org>, click on Contract Opportunities, scroll down to Bus Division and look for Contract No. 2012-BT-4.

Bidders shall also acknowledge the inclusion of Addendum No. 2 by inserting the Addendum number in the space provided on Page P-2 of the Proposal. Failure to do so may cause the District to deem the Proposal as being non-responsive.

Should you have any questions regarding this Addendum, please contact Senior Civil Engineer Laura Pate at (415) 923-2024.

A handwritten signature in blue ink that reads "Janet S. Tarantino". The signature is written in a cursive style and is positioned above a horizontal line.

Janet S. Tarantino
Secretary of the District

JST/KMC/gm

Enclosures

September 2, 2011

ADDENDUM NO. 2

CONTRACT NO. 2012-BT-4
SAN RAFAEL BUS LOT ENTRANCE IMPROVEMENTS

The following changes have been made to Contract No. 2012-BT-4:

DRAWINGS

1. **REPLACE** Drawing Nos. 1, 2, and 3 with the revised attached. Revisions are “bubbled” and denoted with triangular symbols marked “1.”

Attachment: Revised Drawing Nos. 1, 2 and 3



Golden Gate Bridge, Highway & Transportation District

SAN RAFAEL BUS LOT ENTRANCE IMPROVEMENTS

Contract No. 2012-BT-4

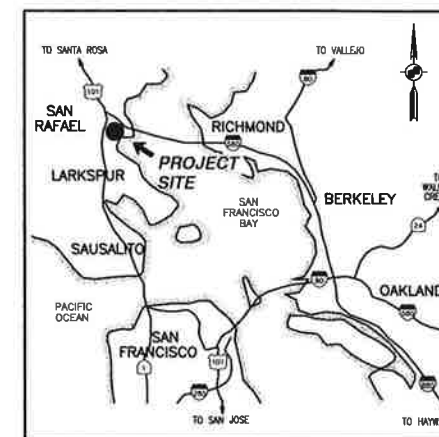

VICINITY MAP
NO SCALE

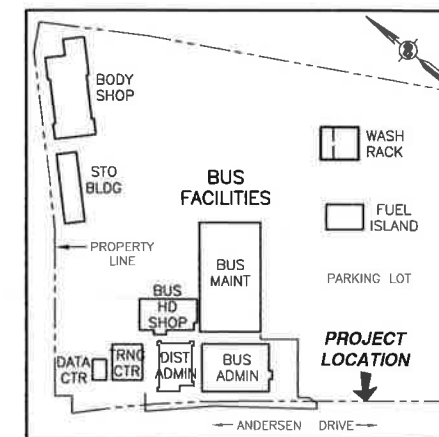

LOCATION PLAN
NO SCALE

DRAWING INDEX:

SHT No.	DWG No.	SHT TITLE
1	1	TITLE SHEET
2	2	GATE TRACK PLAN AND DETAIL
3	3	GATE TRACK SECTION AND DETAIL

ABBREVIATIONS:

AC	ASPHALT CONCRETE
APPR	APPROXIMATE
BET	BETWEEN
BLDG	BUILDING
BOT	BOTTOM
C	CHANNEL
CLR	CLEAR
CONC	CONCRETE
DET	DETAIL
DIST	DISTANCE
DWG	DRAWING
EA	EACH
EL, ELEV	ELEVATION
(E), EXIST	EXISTING
EQ	EQUAL
EXT	EXTERIOR
GR	GRADE
GALV	GALVANIZED
HD	HOT-DIPPED
MAX	MAXIMUM
MFR	MANUFACTURER
MIN	MINIMUM
MISC	MISCELLANEOUS
(N)	NEW
NTS	NOT TO SCALE
OC	ON CENTER
OH	OPPOSITE HAND
PL	PLATE
PVMT	PAVEMENT
(R)	REMOVE
REL	RELOCATED
REQD	REQUIRED
SHT	SHEET
SIM	SIMILAR
SPECS	SPECIFICATIONS
STD	STANDARD
STL	STEEL
SYM	SYMMETRICAL
T.O.	TOP OF
THK	THICK
TYP	TYPICAL
UON	UNLESS OTHERWISE NOTED
VAR	VARIES
VIF	VERIFY IN FIELD
W	WIDTH
W/	WITH

GENERAL NOTES:

1. THE GENERAL CONTRACTOR SHALL POSSESS A VALID STATE OF CALIFORNIA CLASS "A" GENERAL ENGINEERING CONTRACTOR'S LICENSE WITH MINIMUM OF THREE PROJECTS EXPERIENCE WITH PUBLIC AGENCIES IN THE PAST FIVE YEARS. BIDDER TO SUBMIT REFERENCE. FAILURE TO SUBMIT SATISFACTORY QUALIFICATIONS/EXPERIENCE WILL BE CONSIDERED AS NON-RESPONSIVE.
2. ALL SUBCONTRACTOR(S), IF ANY, SHALL BE PROPERLY LICENSED BY THE STATE OF CALIFORNIA TO PERFORM SPECIALIZED TRADES. SUBCONTRACTOR(S) TO HAVE A MINIMUM OF THREE PROJECTS EXPERIENCE WITH PUBLIC AGENCIES IN THE PAST FIVE YEARS. BIDDER TO SUBMIT REFERENCE. FAILURE TO SUBMIT SATISFACTORY QUALIFICATIONS/EXPERIENCE WILL BE CONSIDERED AS NON-RESPONSIVE.
3. NEW CONSTRUCTION IS UNPREFIXED OR PREFIXED BY (N) OR "NEW". EXISTING CONSTRUCTION IS PREFIXED BY (E) OR "EXIST".
4. CONTRACTOR SHALL VERIFY EXISTING CONDITIONS & CONTROLLING FIELD DIMENSIONS PRIOR TO ORDERING OR FABRICATING OF MATERIALS & BEGINNING OF WORK.
5. CONTRACTOR SHALL PERFORM ALL LAYOUT WORK NECESSARY.

SYMBOLS:

- ⊙ AT
 - ⊕ CENTER LINE
 - ∅ DIAMETER
 - ± MORE OR LESS
- SECTION NUMBER
- DETAIL NUMBER
- DWG NUMBER

PROJECT ADDRESS: 1011 ANDERSEN DRIVE
SAN RAFAEL, CALIFORNIA 94901

ADDENDUM No. 2



<p>APPROVED BY</p> <p>PROJECT ENGINEER 08/16/11 DATE</p>	<p>APPROVED BY</p> <p>DISTRICT ENGINEER 08/16/11 DATE</p>	<p>PROJECT TITLE SAN RAFAEL BUS LOT ENTRANCE IMPROVEMENTS</p> <p>SHEET TITLE TITLE SHEET</p> <p>DESIGNED: LMP CHECKED: MWY DRAWN: LMP</p> <p>SCALE: AS-NOTED DATE: 16AUG2011</p>	<p>GOLDEN GATE BRIDGE HIGHWAY & TRANSPORTATION DISTRICT</p>
<p>ADDENDUM No. 2 LP 9/02/11</p> <p>CONTRACT NO. 2012-BT-4 DWG NO. 1</p> <p>CADD FILE: 09T02E001_LMP_ADD_2</p>			

REV NO.	SHEET NO.	SHEET TOTAL
1	2	3

BUS PARKING LOT

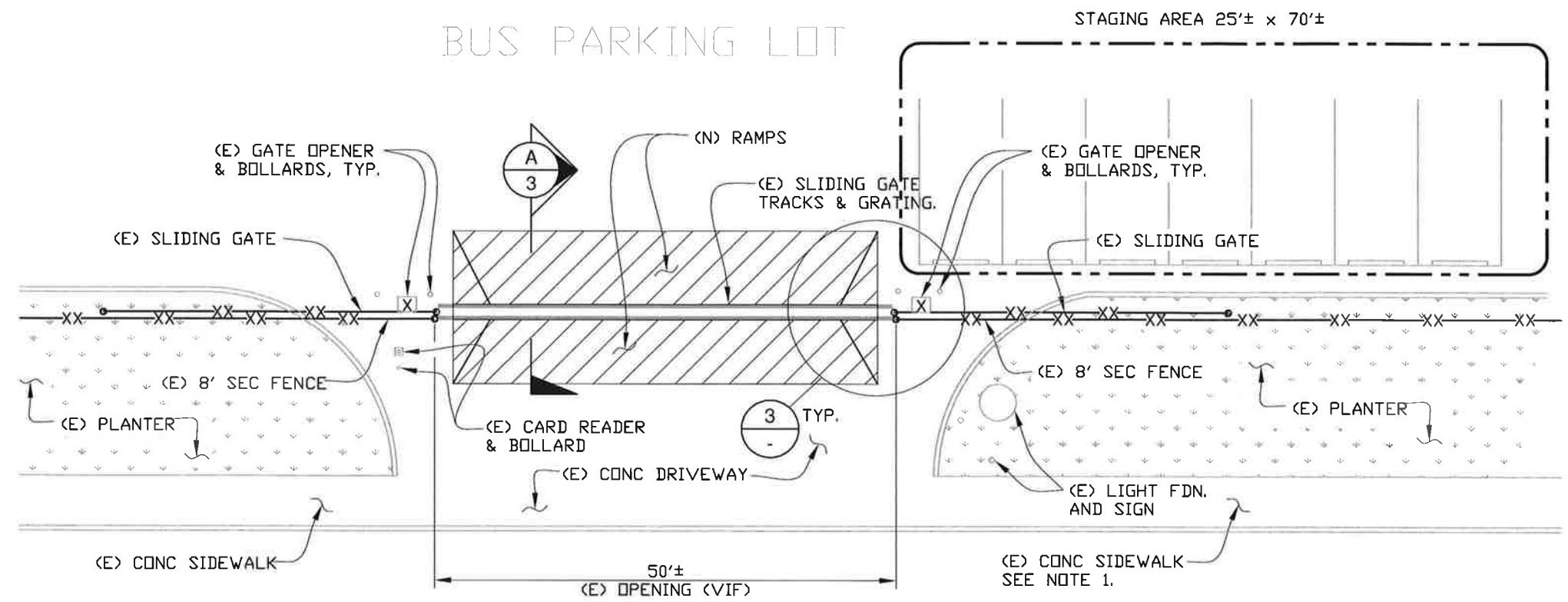

NOTES:

1. SIDEWALK TO REMAIN OPEN AND UNOBSTRUCTED AT ALL TIMES.
2. WORK TO BE STAGED TO ALLOW THE PASSAGE OF BUSES IN AND OUT OF THE GATE DURING NORMAL BUSINESS HOURS. SEE DETAIL 3 FOR WORK STAGING PLAN.
3. WORK AREAS SHALL BE PROTECTED WITH DELINEATORS, BARRICADES AND OTHER DEVICES TO PREVENT UNAUTHORIZED ACCESS AND TO PROTECT THE PUBLIC AND DISTRICT PERSONNEL AT ALL TIMES.
4. FORMWORK FOR STAGE 1 SHALL NOT EXTEND INTO STAGE 2 WORK AREA.

ANDERSEN DRIVE

1 GATE TRACK IMPROVEMENT PLAN
SCALE: 1/8"=1'-0"

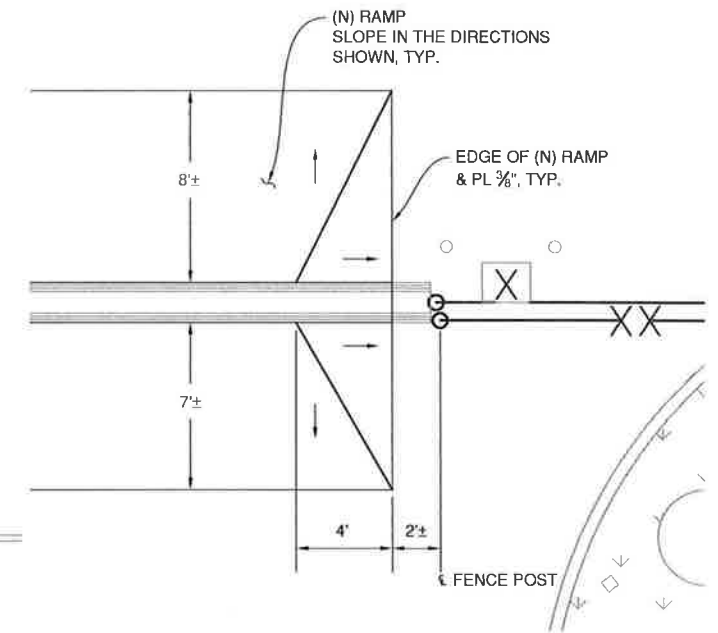
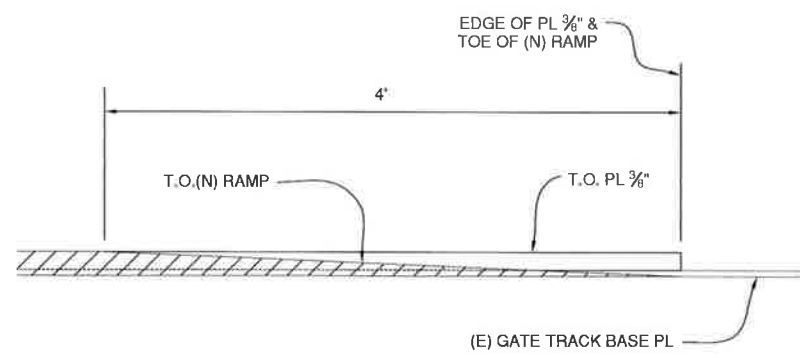
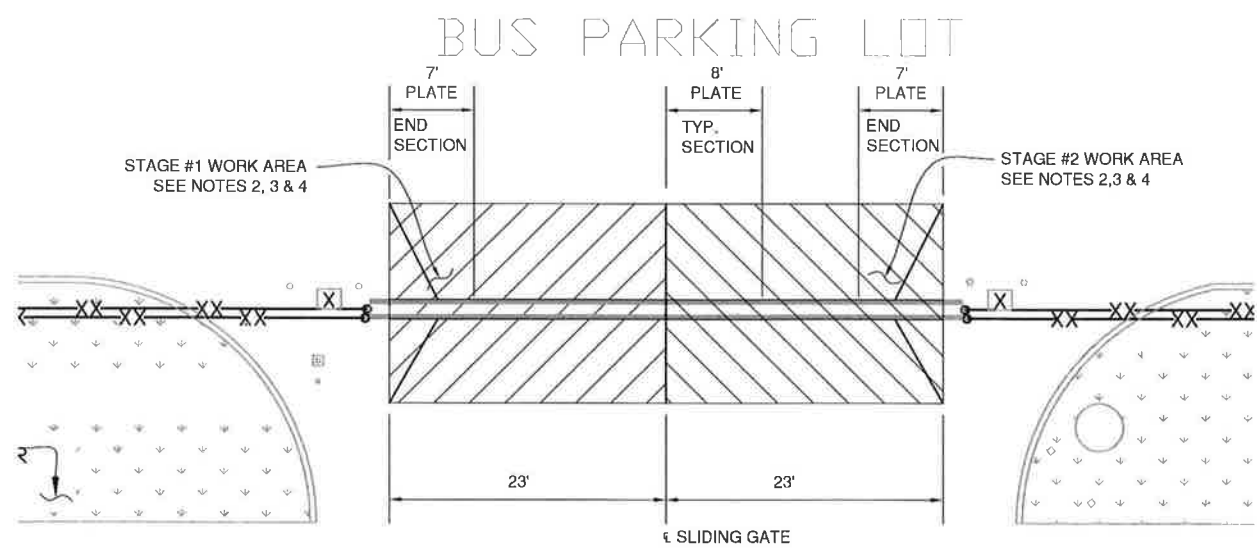

3 GATE TRACK END DETAIL
SCALE: 1/4"=1'-0"

ADDENDUM No. 2

2 WORK STAGING PLAN
SCALE: 1/8"=1'-0"



APPROVED BY PROJECT ENGINEER 08/16/11 DATE	APPROVED BY DISTRICT ENGINEER 08/16/11 DATE	PROJECT TITLE SAN RAFAEL BUS LOT ENTRANCE IMPROVEMENTS	 GOLDEN GATE BRIDGE HIGHWAY & TRANSPORTATION DISTRICT
		SHEET TITLE GATE TRACK PLAN AND DETAIL	
ADDENDUM No. 2 LP: 9/02/11		DATE: 16AUG2011	

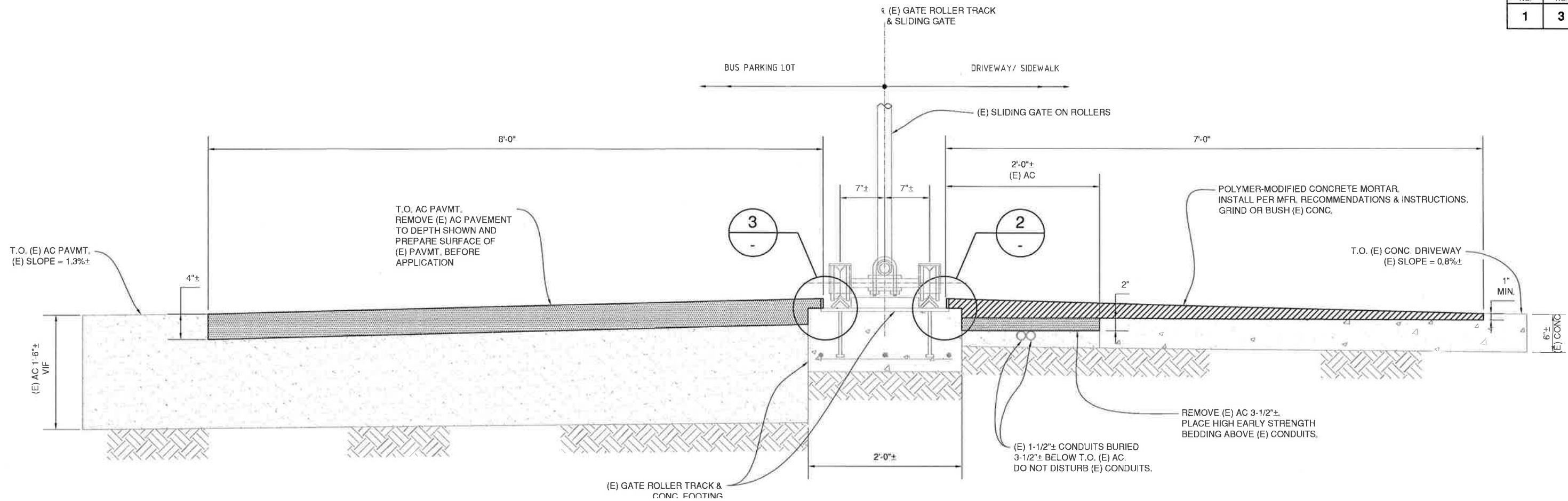

A SLIDING GATE TRACK SECTION
2 SCALE: 1-1/2"=1'-0"

NOTES:

- (N) STEEL PLATE SHALL BE A36 STEEL.
- GALVANIZING ON (E) GATE TRACK BASE PLATE SHALL BE REMOVED IN WELD ZONE PRIOR TO FIELD WELDING. ABRASIVE BLAST CLEAN WELD AREA ON PLATE AND THEN PAINT WITH 2 COATS OF ORGANIC ZINC RICH PRIMER AFTER FIELD WELDING.
- SAWCUT PERIMETER OF ASPHALT CONCRETE AND CONCRETE PAVEMENT AREAS THAT WILL BE REMOVED. SAWCUT 1" MINIMUM.
- NEW RAMPS SHALL BE RECESSED INTO EXISTING PAVEMENT, ALL AROUND.

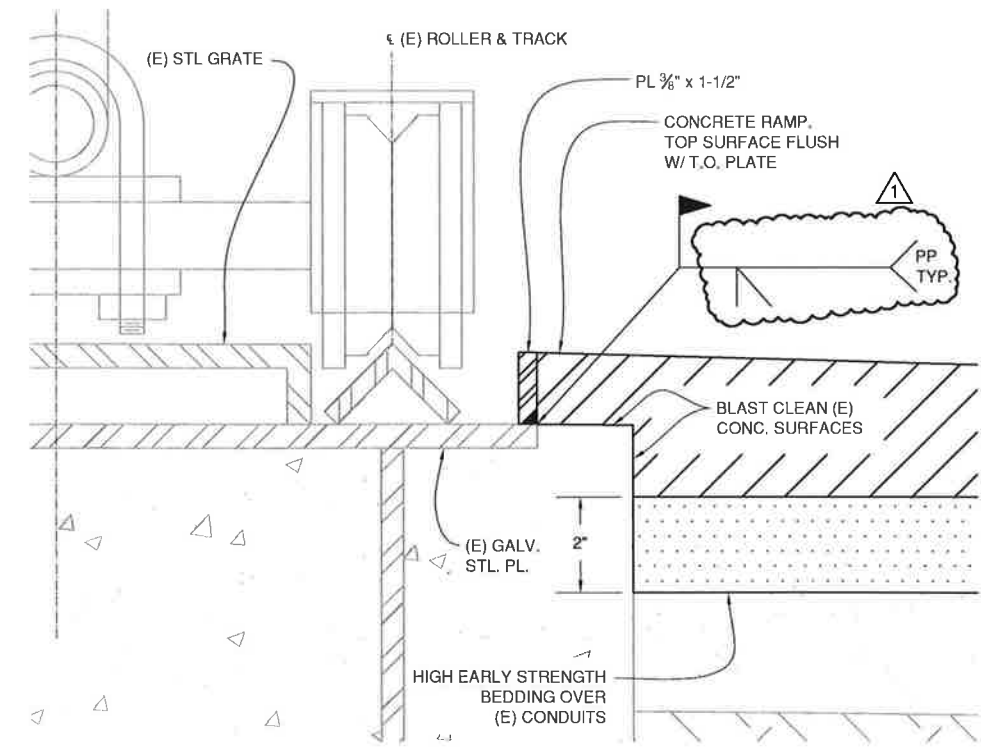

2 SLIDING GATE TRACK DETAIL AT DRIVEWAY/ SIDEWALK
 SCALE: 6"=1'-0"

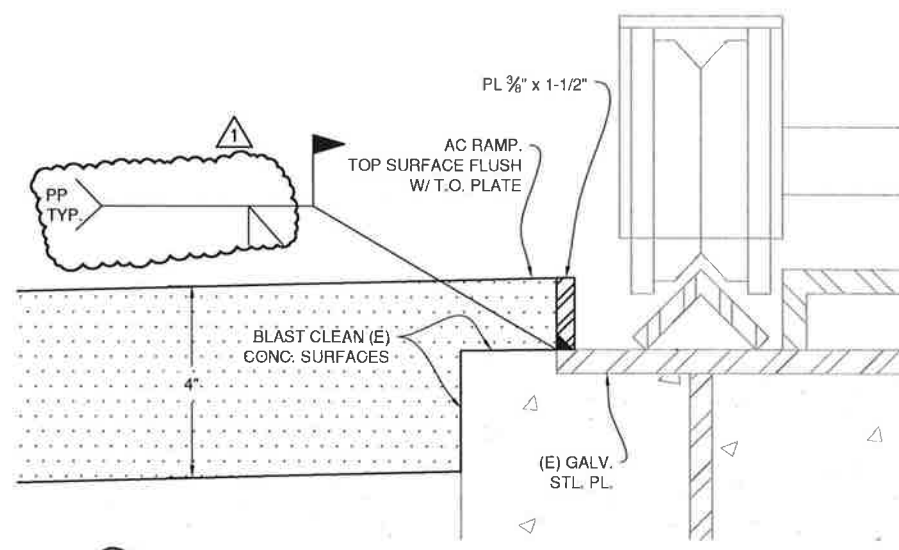

3 SLIDING GATE TRACK DETAIL AT BUS PARKING LOT
 SCALE: 6"=1'-0"

ADDENDUM No. 2

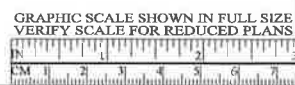

APPROVED BY <i>[Signature]</i> PROFESSIONAL ENGINEER No. C68705 Exp. 9/30/11 CIVIL STATE OF CALIFORNIA	PROJECT ENGINEER DATE 08/16/11	APPROVED BY <i>[Signature]</i> PROFESSIONAL ENGINEER No. C49632 Exp. 9/31/13 CIVIL STATE OF CALIFORNIA	DISTRICT ENGINEER DATE 08/16/11
PROJECT TITLE SAN RAFAEL BUS LOT ENTRANCE IMPROVEMENTS		SHEET TITLE GATE TRACK SECTION AND DETAIL	
CONTRACT NO. 2012-BT-4		DWG NO. 3	
CADD FILE: 09T02E003_LMP_ADD_2		DATE: 16AUG2011	

DESIGNED: LMP	CHECKED: MWY	DRAWN: LMP
SCALE: AS-NOTED		
DATE: 16AUG2011		

